

Menu Page Type Tutorial

In order to add a "Menu" page type you need to access your Application's Dashboard and go to "Edit pages" section. Click on Add New Page button, the "+" button below the list of the currently available pages.

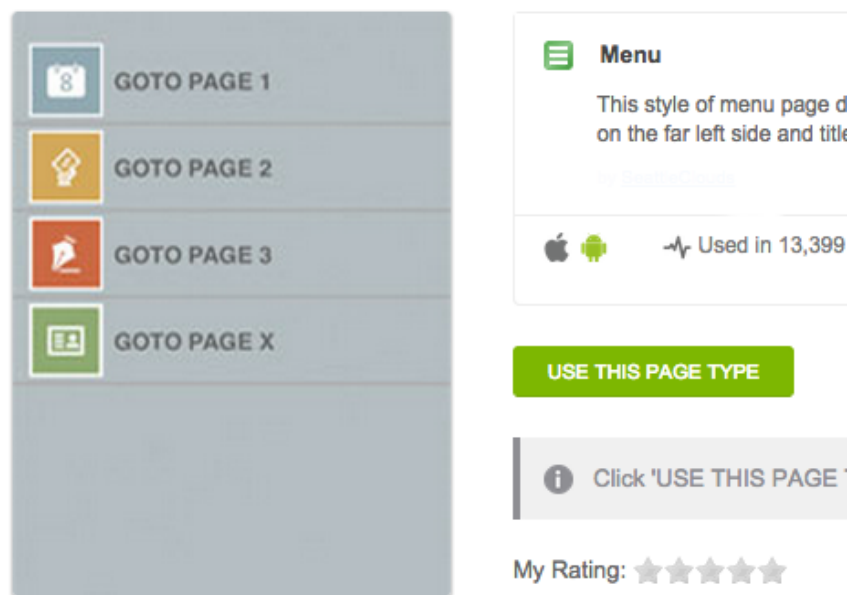
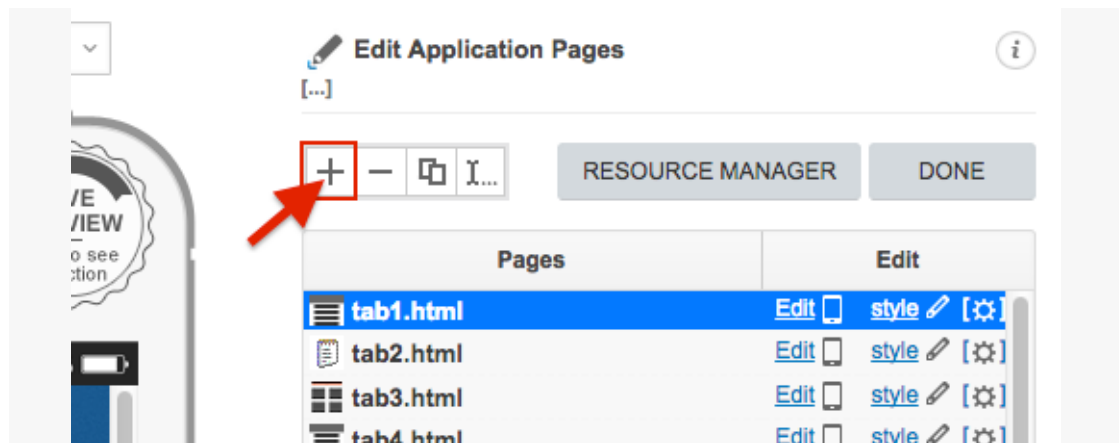

Once added you may go to Edit the page.

Here, you may add as many menu items as you need, just make sure that all of those have other pages linked to each of the item from the list.

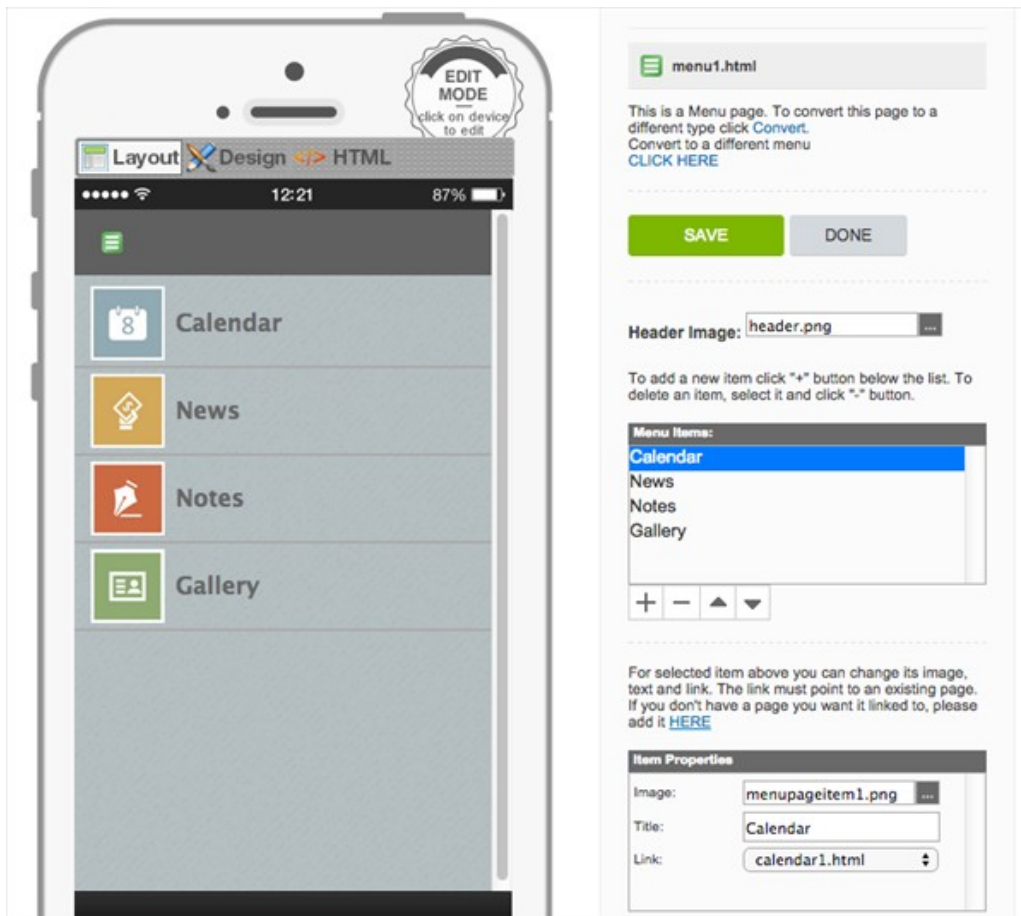

In Edit mode for that page you may change the Header image. You may choose an image already existing in Resource Manager or upload a new one.

In the "Menu Items" section, you may click on "+" button to add more menu items and "-" to delete the existing one. With the controllers you can switch items among them.

Below you may find the Items Proprieties section. Here, you may change the title, image and the Link-To page of the item selected in "Menu Items" section.

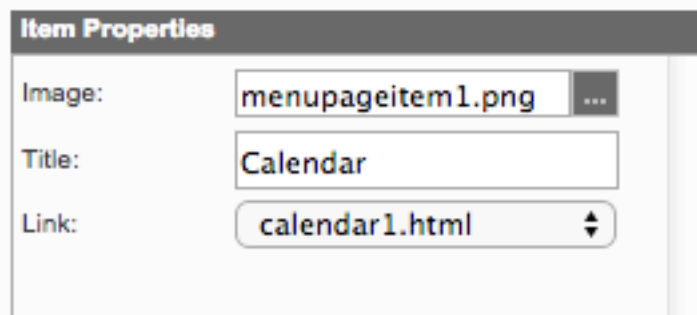

"Menu" page on the device

